

Email Message

From:

[Redacted]

To:

Cc:

Sent:

21/11/2012 at 12:00 AM

Received:

21/11/2012 at 12:00 AM

Subject:

HillClose Fencing stage 5 & 6

Attachments:

Fence stg 5 & 6 for Chirs.pdf

Hi

[Redacted]

Please find attached the package we spoke about today.

If you could come back to me during the week that would be great. The fencing contractor is ready to go we just need a response from a few more residents. Those with a yes are ok, its the remainder that I would appreciate you could approach and confirm they would like a new fence.

FYI I am investigating with the Civil engineers the levels at lot 40 Keppel ave, following a conversation with the residents there.

Regards

[Redacted]

Development Manager

ulda I Level 4, 229 Elizabeth Street, QLD 4000 Australia
GPO Box 2202 Brisbane QLD 4001 Australia

[Redacted]

E [HYPERLINK "mailto:Tyson.Quig@ulda.qld.gov.au"](mailto:Tyson.Quig@ulda.qld.gov.au)Tyson.Quig@ulda.qld.gov.au | W
[HYPERLINK "http://www.ulda.qld.gov.au"](http://www.ulda.qld.gov.au)www.ulda.qld.gov.au

RTI RE



RTI RELEASED UNDER THE OFFICIAL INFORMATION ACT

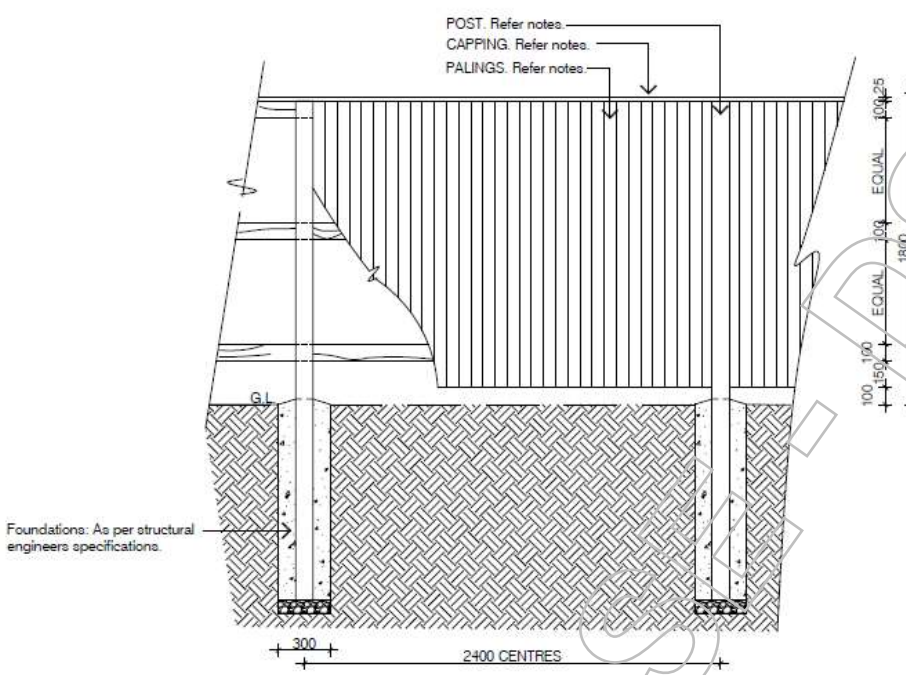

- NOTES:**
1. PALINGS: to be CCA pressure treated pine 100 X 16mm to AS1604 Hazard 3. Fix palings with 2 (No.) 50mm x 2.5mm screw shank or ring shank HDG nails to each rail.
 2. PALING LOCATIONS: Fix palings to rails as shown. Overlap of palings to be 30mm.
 3. POSTS: F14 HWD Tanalith E treated to Hazard 4. Aris all edges. All posts to be 100 x 100mm, evenly spaced with a maximum spacing of 2400mm.
 4. RAILS: F14 HWD Tanalith E treated to Hazard 4 100 x 50mm. Butt join rails as shown on alternative posts where possible. Screw rails to posts with 1 (No.) Type 17 100mm Bugle Headed Batten Screw. Aris all edges.
 5. FITTINGS: Hot dip galvanise all screws and fittings. Coat with a film of grease or a bitumastic product before use.
 6. CAPPING: 150 x 25mm capping piece CCA pressure treated pine to AS1604 Hazard 3. Top edges to be arised.

ELEVATION OF FENCE - SCALE 1:20@A1; 1:40@A3

02 FENCE TYPE 2 - LAPPED AND CAPPED TIMBER PALING WITH GAP AT BOTTOM FENCE
CD-D-02/ AS SHOWN

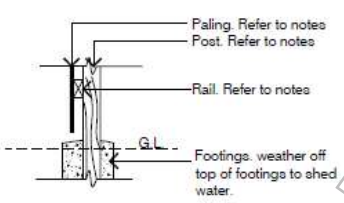

DETAILED SECTION - BOTTOM OF FENCE - SCALE 1:20@A1; 1:40@A3

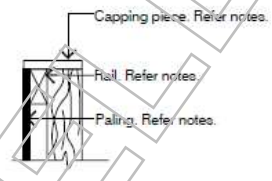

DETAILED SECTION - TOP OF FENCE - SCALE 1:10@A1; 1:20@A3

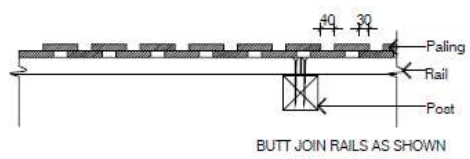

DETAILED PLAN - 1:10@A1; 1:20@A3

TENDER	2011/02/08	MC	GT
CLIENT APPROVAL	2011/01/12	EP	GT
PRELIMINARY	2010/12/17	EP	GT
PRELIMINARY	2010/12/07	EP	GT
ISSUE	AMENDMENT	DATE	DRWN CHWD

COPYRIGHT
THE DESIGN ILLUSTRATED IN THESE DOCUMENTS IS THE EXCLUSIVE PROPERTY
OF GAMBLE MCKINNON GREEN PTY. LTD. AND MUST NOT BE
REPRODUCED OR USED IN WHOLE OR IN PART WITHOUT THE EXPRESS
WRITTEN PERMISSION OF GAMBLE MCKINNON GREEN.

**TENDER ONLY
NOT FOR CONSTRUCTION**

GAMBLE MCKINNON GREEN

BRISBANE
6 SANDLIDGE STREET
P.O. BOX 5149
WEST END Q 4011
TEL: 1 5446 1103
FAX: 1 5446 5098
OFFICE@GAM.COM.AU

GLADSTONE
1 GANNANBARRA STREET
DURBALLOO Q 4551
P.O. BOX 110
MURTLILLA Q 4575
TEL: 1 5437 1111
FAX: 1 5437 1422

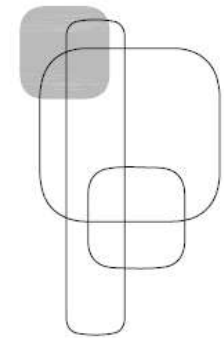

TITLE DETAILS - FENCING

PROJECT HARVEY ROAD, GLADSTONE FOR ULDA

SCALE AS SHOWN
DRAWING NO 10075A-CD-D-02
PROJECT NO. 10075A

(SUNSHINE COAST)
DATE PLOTTED: 18 September 2012 10:47 AM BY:

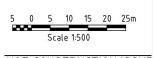
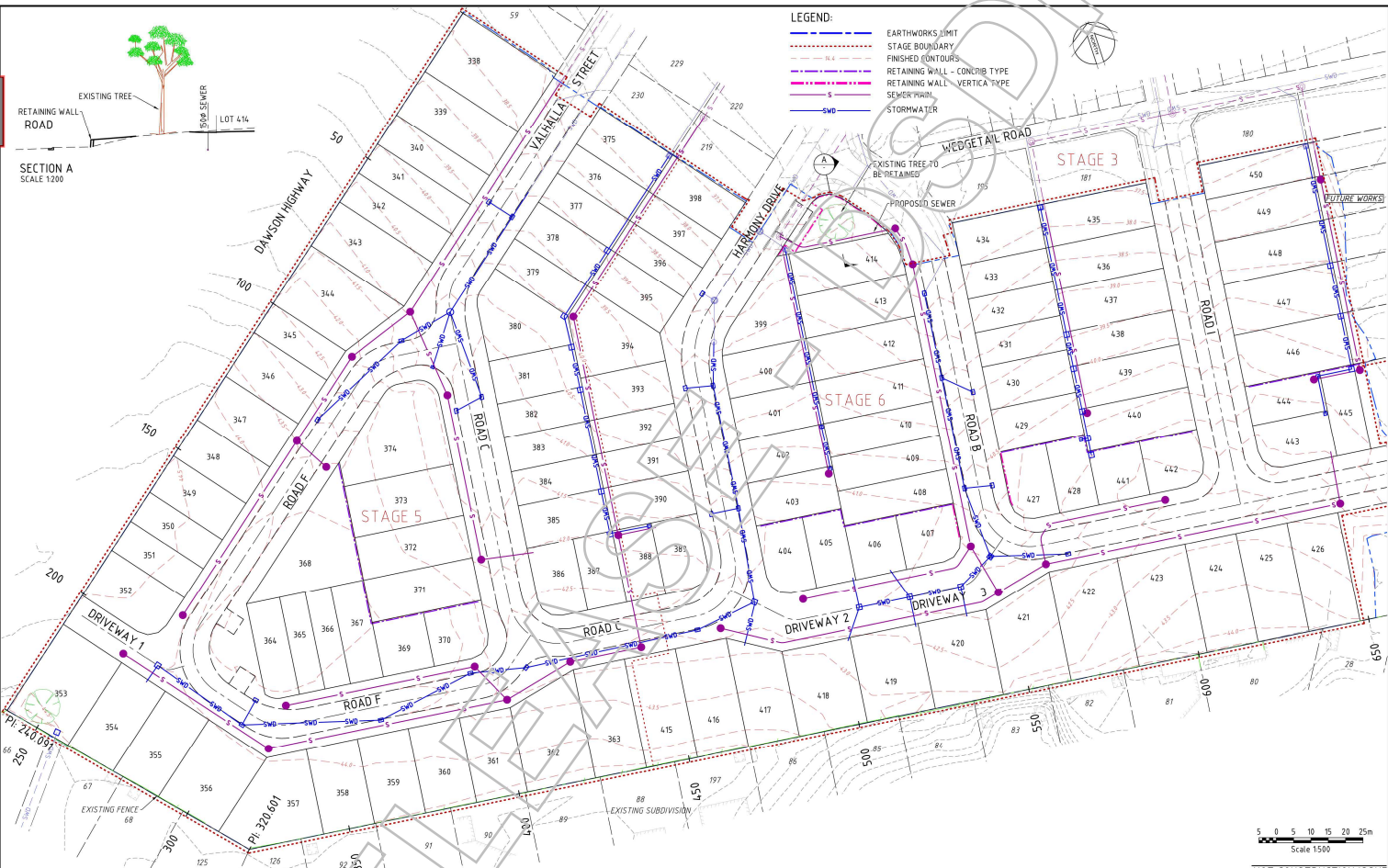
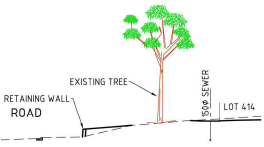

NOT CONSTRUCTION ISSUE

Rev	Date	Description	N.I.K.	H.T.
A	16/09/2012	WALLS REMOVED FROM SOUTHERN BOUNDARY		

Cardno
Cardno (Qld) Pty Ltd
SUNSHINE COAST OFFICE: Level 7, 70, Myriad Street, Manorochydons, Qld 4556
Phone: (07) 5443 5000 Fax: (07) 5443 5642

© Cardno (Qld) Pty Ltd All Rights Reserved 2012.
Copyright in the name and design of this drawing is owned by Cardno (Qld) Pty Ltd and may not be used, reproduced, copied or reproduced in whole or in part in any form or by any means, for any purpose other than that approved in writing by Cardno (Qld) Pty Ltd.
This document is prepared by Cardno (Qld) Pty Ltd solely for the benefit and use of the client in accordance with the terms of the contract between Cardno (Qld) Pty Ltd and the client. The client is responsible for the accuracy of the information provided and for any use or reliance on this document.

Drawn	Date	Checked	Date	Approved	Date
SG	20/09/2012	SG		SG	

URBAN LAND DEVELOPMENT AUTHORITY			
HILL CLOSE ESTATE - STAGE 5 GLADSTONE, QUEENSLAND			
Date	Drawn	Scale	Sheet
20/09/2012	AHD	AS SHOWN	A1
PROJECT NUMBER			Revised
R122207-56-SK02			

ON A1 ORIGINAL

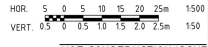
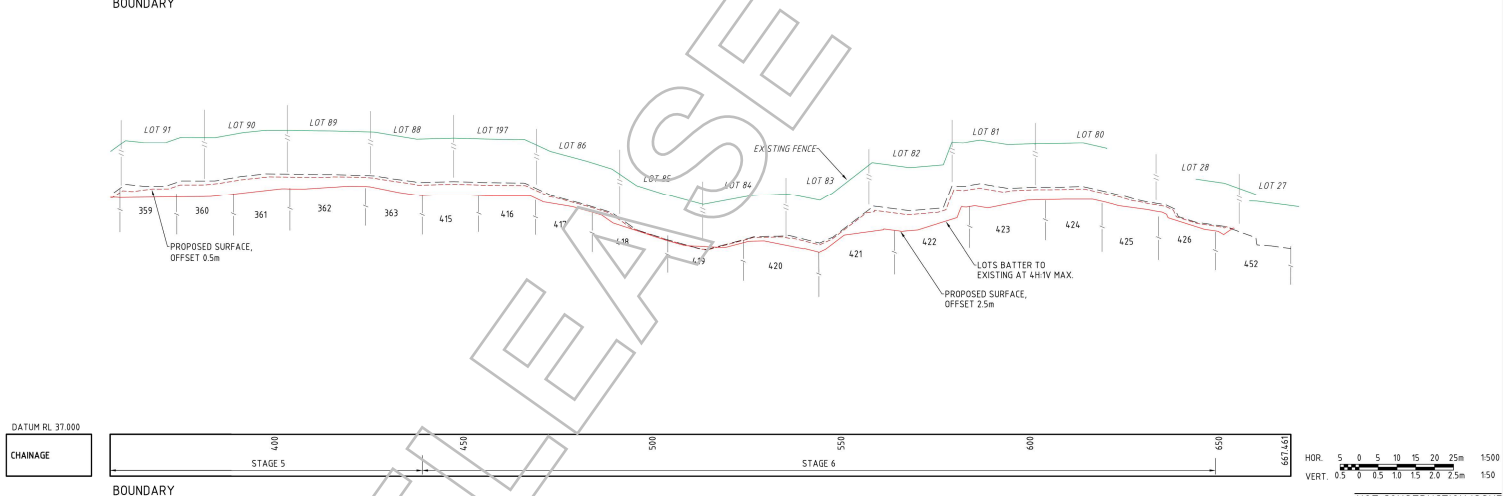
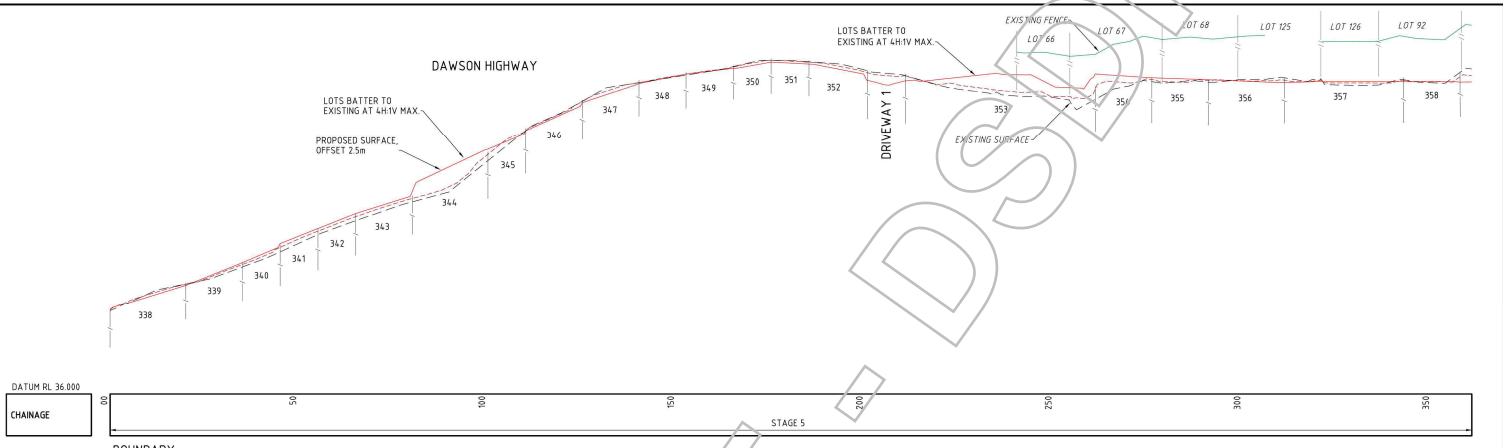

No.	Date	Description	N.I.K.	R.T.
A	16/03/2012	WALLS REMOVED		

Cardno
Cardno (Qld) Pty Ltd
SUNSHINE COAST OFFICE: Level 7, 10, Myland Street Maroochydore, Qld 4556
SIR@csd@cardno.com.au Ph: (07) 5443 5000 Fax: (07) 5443 5042

© Cardno (Qld) Pty Ltd All Rights Reserved 2012.
Cardno is the name and service mark of the company managed by Cardno (Qld) Pty Ltd and may be used with its trademark, logo or reproduced whole or in part in any manner or form or in any media, for the purpose other than the agreement with Cardno (Qld) Pty Ltd.
This document is produced by Cardno (Qld) Pty Ltd solely for the benefit and use of the client in accordance with the terms of the relevant contract. Cardno (Qld) Pty Ltd does not warrant the accuracy or safety of information in any third party survey and of any use or reliance by third parties on the content of this document.

Drawn	Date	Scale
SJK		
Checked	Date	
20/09/12		
Checked	Date	
SJK		
Approved	Date	
SJK		

URBAN LAND DEVELOPMENT AUTHORITY
HILL CLOSE ESTATE - STAGE 5
GLADSTONE, QUEENSLAND
STAGES 5 AND 6 EXTERNAL BOUNDARY SECTION

NOT CONSTRUCTION ISSUE			
PRELIMINARY			
Date	Drawn	Scale	Sheet
20/09/2012	AHD	AS SHOWN	A1
Project No.	R122207-56-SK03		Revised
			A

1:1 ON A1 ORIGINAL

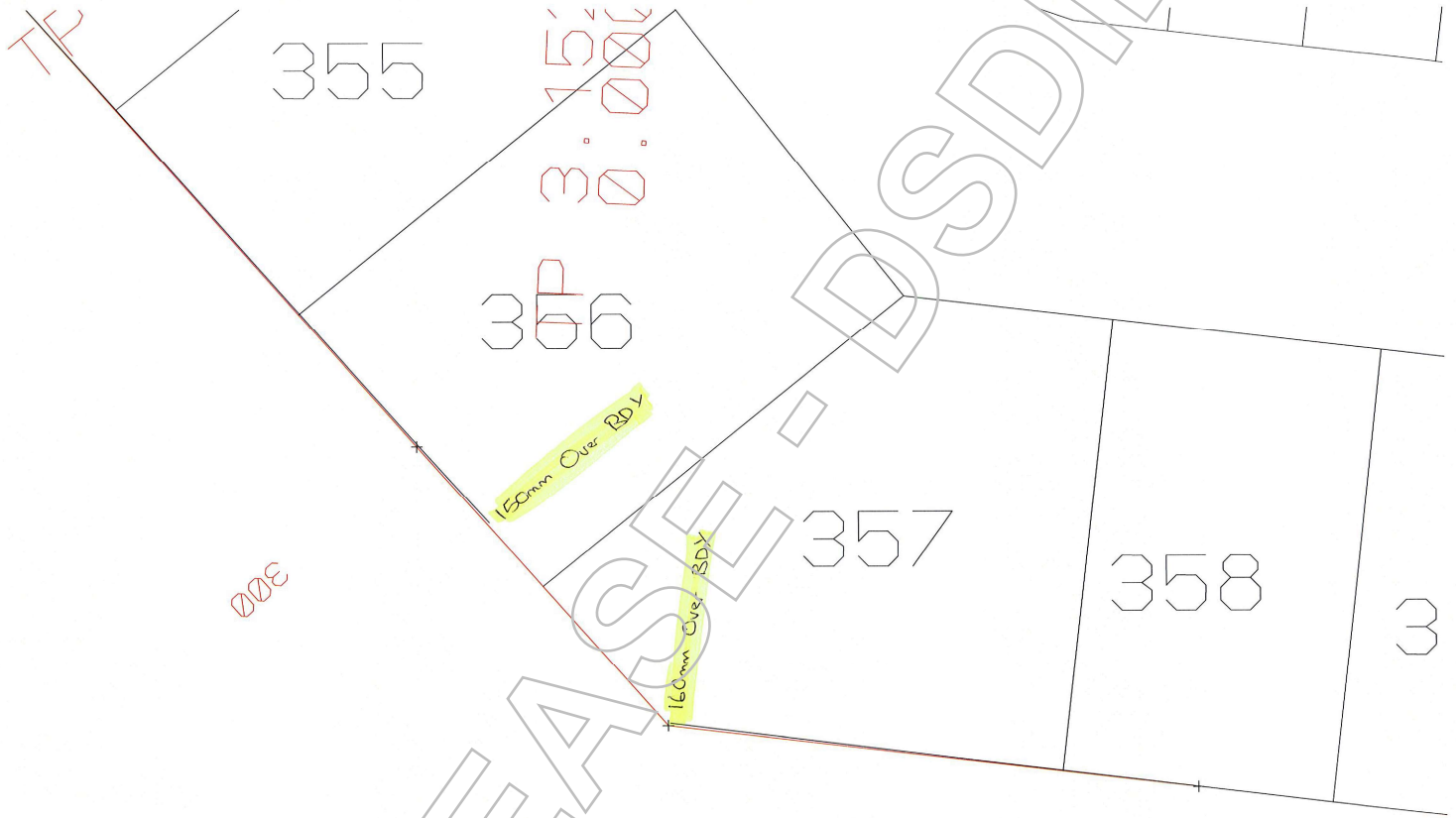

Harvey Stage 5 & 6 Fence Survey
 [Redacted] Shadforth Civil 12/10/12

320.607

Pg 1 of 3

RTI RELEASE - DSDIL GP

7

418

419

420

421

1.20mm
Over B.D.Y

500

550

Pg 2 of 3

RTI RELEASED UNDER DSDIL GP

423

424

425

426

140mm Over BDX

90mm Over BDX

Face of shed

009

650

RTI RELEASE - DSDIL GP