

24 January 2024

Office of the Coordinator-General

PO Box 15517
CITY EAST QLD 4002

Attention: Mr Michael Moran

Dear Michael,

RE: ALLANS CREEK POULTRY FARM – CHANGE APPLICATION APC2022/005 – REQUEST TO CHANGE APPLICATION

PSA Consulting has been engaged by Allans Creek Poultry Farm Pty Ltd (the Applicant) to prepare a Change Application which seeks approval from the Coordinator General (CG) to change both conditions and approved plans associated with the existing Development Approval. As per the correspondence received from the Office of the CG on 18 December 2023 (OUT23/5059) and in accordance with section 3(2) of the Bromelton SDA Development Scheme, the Coordinator-General has agreed to place the Change Application on hold until 1 March 2024.

As you are aware, the site has recently been acquired and is now being operated by Proten, Australia's largest grower of broiler chickens. As part of this process and in accordance with recent changes requested by the processor (Inghams), Proten need to amend some aspects of the current change application, including allowing the site to operate as either barn or free range.

In this regard, ProTen have requested changes to the proposed layout as per the attached plans. Allowance also now needs to be made in the development conditions for the site to be operated as a free-range farm, should it be requested by the processor in the future.

Specifically, the amendments to the current change application will include:

- The ability to convert to a free-range operation is to be retained;
- Space for the access road around the sheds will be retained, however this road will not be sealed unless requested by the processor;
- The additional 4 sheds are to be spread further apart to provide additional free-range spaces between the sheds while retaining a minimum 100m setback to Allans Creek; and
- The stormwater management arrangements will be updated to ensure they are capable of treating runoff from free-range areas.

All other aspects of the operation including bird numbers, day to day operations, traffic will not change because of the proposed amendments.

To facilitate these amendments, updates to the application material are being prepared including:

- Updated Development Plans.
- Updated Civil Engineering Plans.
- Updated Site Based Management Plan.
- Updated Stormwater Management Plan.
- Updated Planning Report.

We are seeking confirmation from the Office of the Co-ordinator General that the proposed amendments can be incorporated by a change to the current change application, and that the updated documentation listed above is sufficient to enable assessment and determination of the application.

If you have any questions or require anything further with respect to this matter, please contact me on 0416 016 580 to discuss.

Kind regards,

A handwritten signature in black ink, appearing to read 'D Ireland'.

David Ireland
Director – Planning
PSA Consulting (Australia) Pty Ltd

ATTACHMENT 1 – UPDATED SITE PLANS

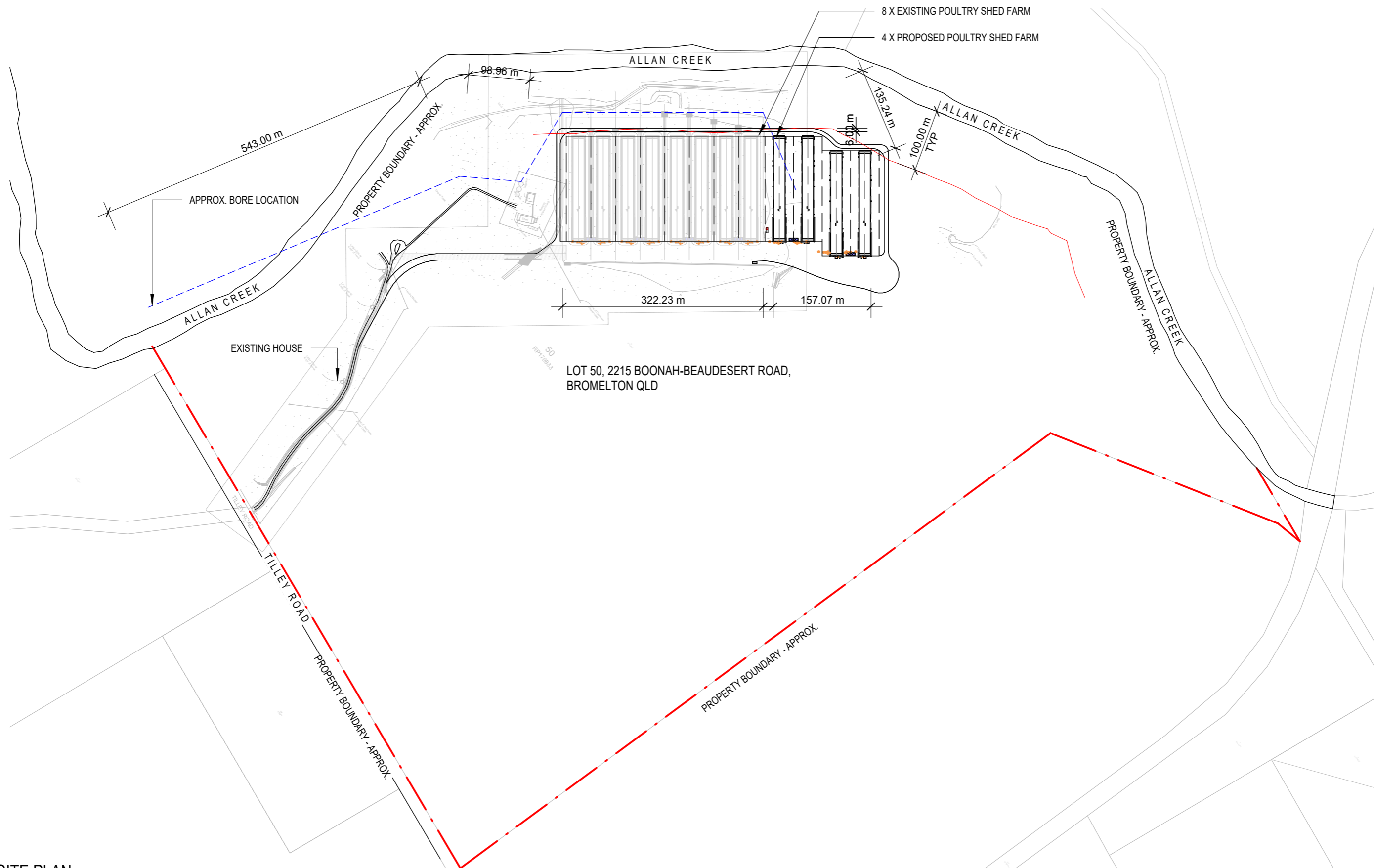

LOT 50, 2215 BOONAH-BEAUDESERT ROAD,
BROMELTON QLD

1 SITE PLAN
1 : 6000

DA SET



© COPYRIGHT 2012 - SANTREV PTY LTD
THE IDEAS AND CONCEPTS CONTAINED WITHIN THIS DOCUMENT AND THE DOCUMENT ITSELF REMAIN THE INTELLECTUAL PROPERTY OF SANTREV PTY LTD AND MAY NOT BE COPIED OR REPRODUCED IN PART OR IN WHOLE WITHOUT EXPRESSED WRITTEN PERMISSION FROM THE DIRECTORS OF SANTREV PTY LTD.

ABN: 43 124 970 878
BSA QLD: 1214566
OCBA SA: 277785
BC VIC: CB-U 44246

Phone: 1300 815 888 (+61) 07 3281 3200
Fax: 1300 816 888 (+61) 07 3281 8295
Email: enquiries@santrev.com.au
Web: www.santrev.com.au

GENERAL NOTES

- ALL DIMENSIONS ARE IN mm (millimetres) UNLESS NOTED OTHERWISE

REV	DESCRIPTION	DATE
A	DA SET	14/12/23
B	UPDATED TURNING CIRCLE	21/12/23

ALLAN CREEK POULTRY FARM

FOR:
PROJECT ADDRESS:

75 TILLEY ROAD, BROMELTON
QLD 4285

SHEET TITLE: SITE PLAN	
JOB No.: TILQ-1	DRAWN BY: SP
SCALE (A3): 1 : 6000	REV: B
DATE: 14/12/2023	DRG No: D 01

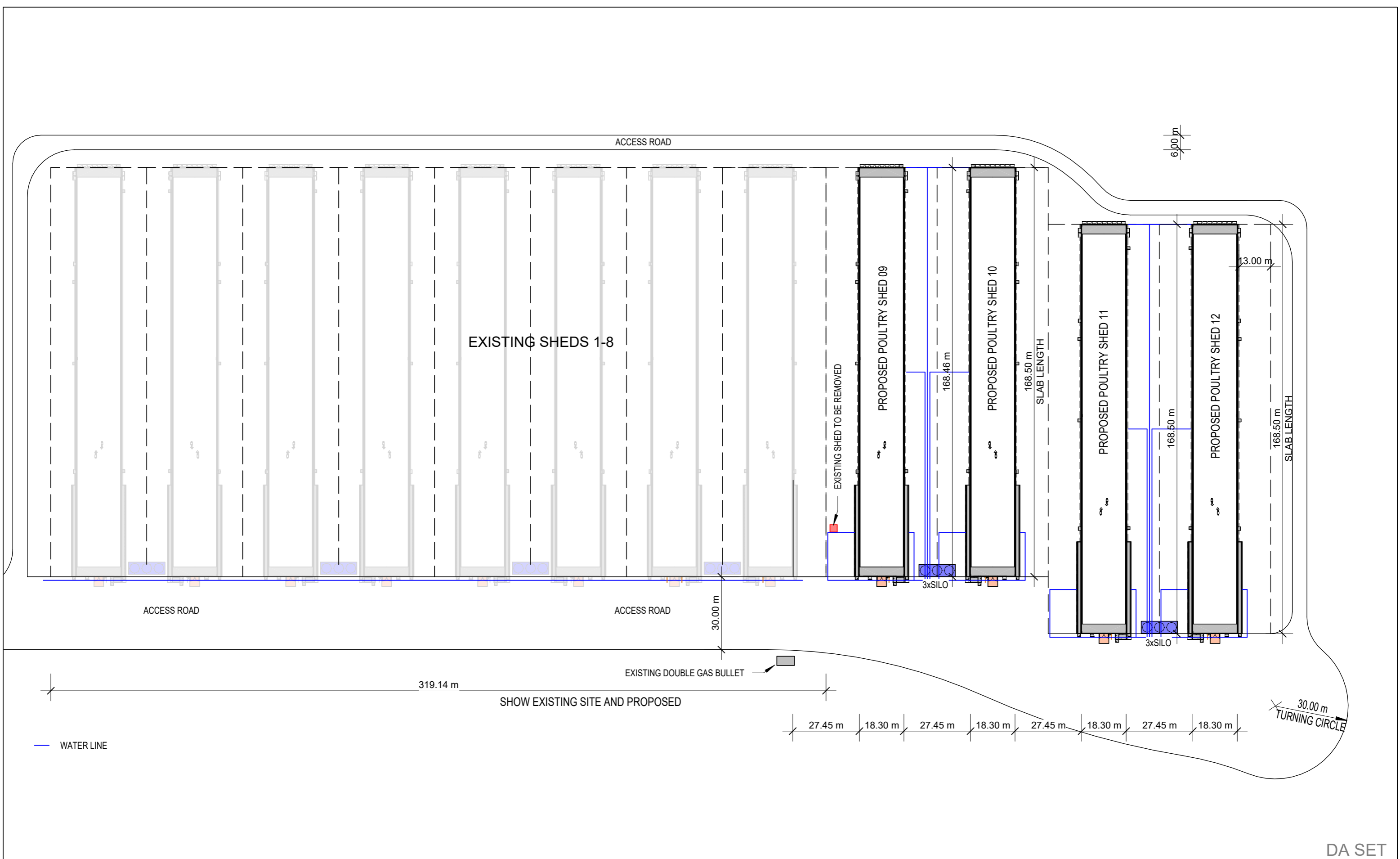

DA SET



© COPYRIGHT 2012 - SANTREV PTY LTD
 THE IDEAS AND CONCEPTS CONTAINED WITHIN THIS DOCUMENT AND THE DOCUMENT ITSELF REMAIN THE INTELLECTUAL PROPERTY OF SANTREV PTY LTD AND MAY NOT BE COPIED OR REPRODUCED IN PART OR IN WHOLE WITHOUT EXPRESSED WRITTEN PERMISSION FROM THE DIRECTORS OF SANTREV PTY LTD.

ABN: 43 124 970 878
 BSA QLD: 1214566
 OCBA SA: 277785
 BC VIC: CB-U 44246

Phone: 1300 815 888 (+61) 07 3281 3200
 Fax: 1300 816 888 (+61) 07 3281 8295
 Email: enquiries@santrev.com.au
 Web: www.santrev.com.au

GENERAL NOTES

- ALL DIMENSIONS ARE IN mm (millimetres) UNLESS NOTED OTHERWISE

REV	DESCRIPTION	DATE
A	DA SET	14/12/23
B	UPDATED TURNING CIRCLE	21/12/23

ALLAN CREEK POULTRY FARM

FOR:
 PROJECT ADDRESS:
 75 TILLEY ROAD, BROMELTON
 QLD 4285

SHEET TITLE: FARM LAYOUT	
JOB No.: TILQ-1	DRAWN BY: SP
SCALE (A3): 1 : 1400	REV: B
DATE: 14/12/2023	DRG No: D 02